

RESOLUTION NO. 21-46

RESOLUTION TO EXPAND RURAL SPECIAL  
IMPROVEMENT MAINTENANCE DISTRICT #851M  
(SHOP WORLD 1 SUBDIVISION)

WHEREAS, pursuant to §7-12-2161(4), MCA, the Commissioners have the power of changing, by resolution, the boundaries of any maintenance district not more than once a year; and

WHEREAS the boundaries of RSID 851M have not been changed within the last year; and

WHEREAS, it has been determined that properties adjacent to the existing Rural Special Improvement District #851M boundaries are benefited properties accessing the district dry hydrant; and

WHEREAS, the benefited property status requires the expansion of boundaries for RSID 851M for the maintenance of the dry hydrant within the district; and

WHEREAS, the boundaries of the district will be expanded to include tax codes C18035-C18041, and C18044-C18050, Yellowstone County, Montana; and

WHEREAS, lots to be added to the district and boundaries of the expanded district are shown in Exhibit A (map).

NOW, THEREFORE, BE IT RESOLVED by the Board of County Commissioners of Yellowstone County, Montana, deeming the public interest or convenience require, will expand the following described Rural Special Improvement Maintenance District:

- 1. DESCRIPTION OF IMPROVEMENTS, DESCRIPTION OF MAINTENANCE, METHOD OF ASSESSMENT AND ESTIMATED COSTS.** Assessments collected on behalf of this district shall be used for the maintenance, preservation, and repair of the dry hydrant located within the boundaries of this district. All of the costs of the district shall be assessed equally on a per lot method for existing and future lots. Assessments will be established annually by the Board of County Commissioners and are subject to adjustment due to cost fluctuations related to maintenance utilization levels and changes in material and labor costs of performing necessary maintenance.
- 2. DURATION.** The district shall be deemed to be perpetual in nature unless absorbed and replaced by another district or municipality.

Page 2  
Resolution to Expand  
RSID #851M

PASSED AND ADOPTED by the Board of County Commissioners of Yellowstone  
County, Montana, this 6<sup>th</sup> day of July 2021.

BOARD OF COUNTY COMMISSIONERS  
YELLOWSTONE COUNTY, MONTANA

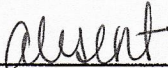
  
\_\_\_\_\_  
Donald Jones, Chairman

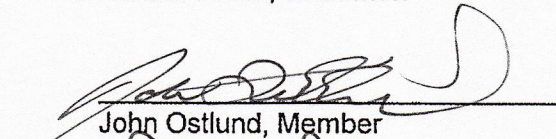
  
\_\_\_\_\_  
John Ostlund, Member

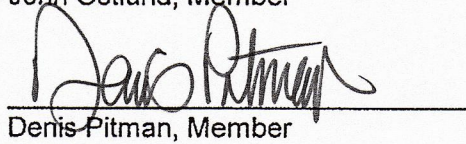
  
\_\_\_\_\_  
Denis Pitman, Member

(SEAL)  
ATTEST:

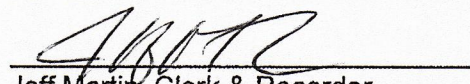
  
\_\_\_\_\_  
Jeff Martin, Clerk & Recorder  
Yellowstone County, Montana

# EXHIBIT A

## RSID 851M

RSID 851M  
Expansion Area

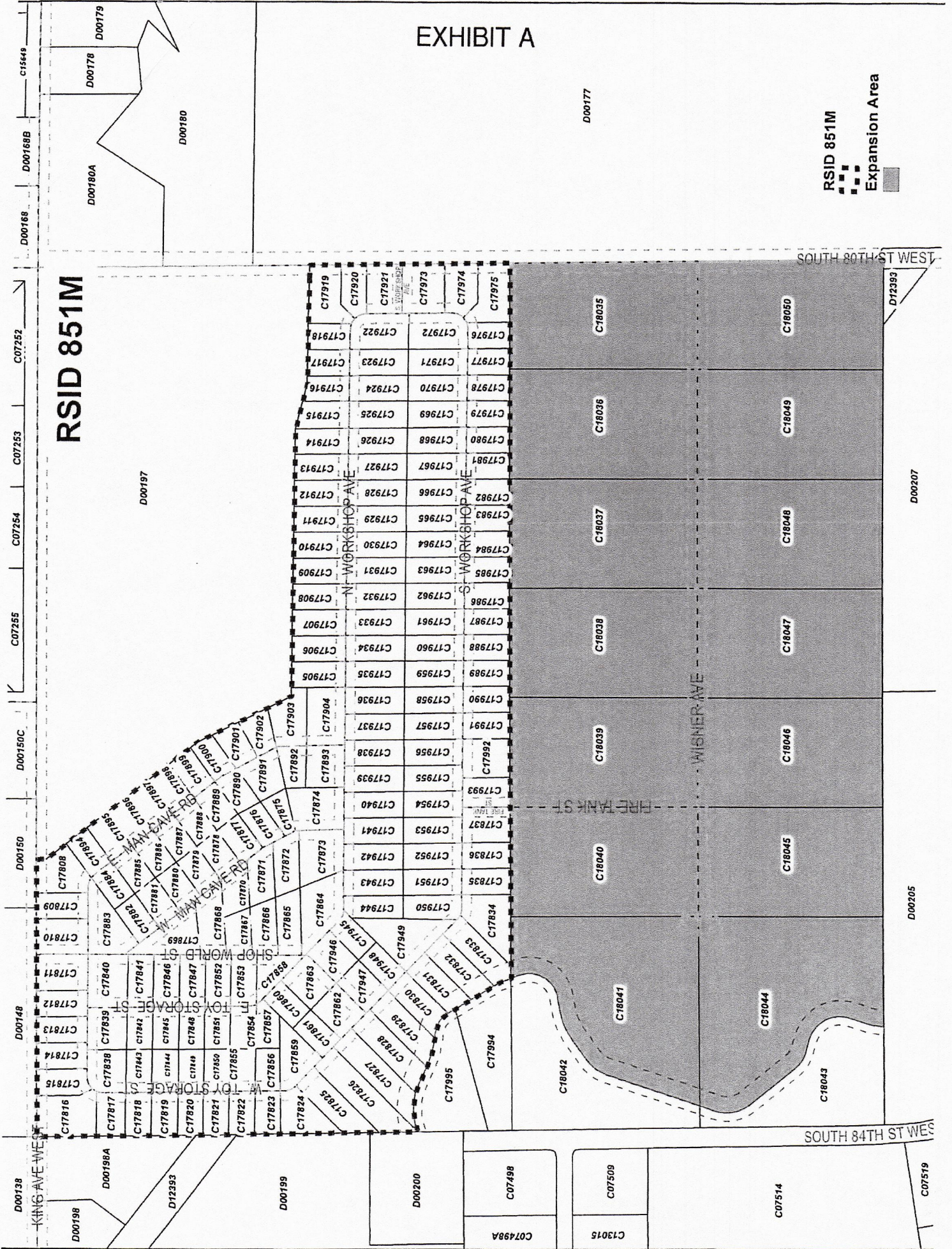

D00138  
D00198  
D00199  
D00200  
C07498  
C07509  
C13015  
C07514  
C07519

D00138  
D00198  
D00199  
D00200  
C07498  
C07509  
C13015  
C07514  
C07519

D00138  
D00198  
D00199  
D00200  
C07498  
C07509  
C13015  
C07514  
C07519

D00138  
D00198  
D00199  
D00200  
C07498  
C07509  
C13015  
C07514  
C07519

D00138  
D00198  
D00199  
D00200  
C07498  
C07509  
C13015  
C07514  
C07519

D00138  
D00198  
D00199  
D00200  
C07498  
C07509  
C13015  
C07514  
C07519

D00138  
D00198  
D00199  
D00200  
C07498  
C07509  
C13015  
C07514  
C07519

D00138  
D00198  
D00199  
D00200  
C07498  
C07509  
C13015  
C07514  
C07519

D00138  
D00198  
D00199  
D00200  
C07498  
C07509  
C13015  
C07514  
C07519

D00138  
D00198  
D00199  
D00200  
C07498  
C07509  
C13015  
C07514  
C07519

D00138  
D00198  
D00199  
D00200  
C07498  
C07509  
C13015  
C07514  
C07519

D00138  
D00198  
D00199  
D00200  
C07498  
C07509  
C13015  
C07514  
C07519

D00138  
D00198  
D00199  
D00200  
C07498  
C07509  
C13015  
C07514  
C07519

D00138  
D00198  
D00199  
D00200  
C07498  
C07509  
C13015  
C07514  
C07519

D00138  
D00198  
D00199  
D00200  
C07498  
C07509  
C13015  
C07514  
C07519

D00138  
D00198  
D00199  
D00200  
C07498  
C07509  
C13015  
C07514  
C07519

D00138  
D00198  
D00199  
D00200  
C07498  
C07509  
C13015  
C07514  
C07519

D00138  
D00198  
D00199  
D00200  
C07498  
C07509  
C13015  
C07514  
C07519

D00138  
D00198  
D00199  
D00200  
C07498  
C07509  
C13015  
C07514  
C07519

D00138  
D00198  
D00199  
D00200  
C07498  
C07509  
C13015  
C07514  
C07519

D00138  
D00198  
D00199  
D00200  
C07498  
C07509  
C13015  
C07514  
C07519

D00138  
D00198  
D00199  
D00200  
C07498  
C07509  
C13015  
C07514  
C07519

D00138  
D00198  
D00199  
D00200  
C07498  
C07509  
C13015  
C07514  
C07519

D00138  
D00198  
D00199  
D00200  
C07498  
C07509  
C13015  
C07514  
C07519

D00138  
D00198  
D00199  
D00200  
C07498  
C07509  
C13015  
C07514  
C07519

D00138  
D00198  
D00199  
D00200  
C07498  
C07509  
C13015  
C07514  
C07519

D00138  
D00198  
D00199  
D00200  
C07498  
C07509  
C13015  
C07514  
C07519

D00138  
D00198  
D00199  
D00200  
C07498  
C07509  
C13015  
C07514  
C07519

D00138  
D00198  
D00199  
D00200  
C07498  
C07509  
C13015  
C07514  
C07519

D00138  
D00198  
D00199  
D00200  
C07498  
C07509  
C13015  
C07514  
C07519

D00138  
D00198  
D00199  
D00200  
C07498  
C07509  
C13015  
C07514  
C07519

D00138  
D00198  
D00199  
D00200  
C07498  
C07509  
C13015  
C07514  
C07519

D00138  
D00198  
D00199  
D00200  
C07498  
C07509  
C13015  
C07514  
C07519

D00138  
D00198  
D00199  
D00200  
C07498  
C07509  
C13015  
C07514  
C07519

D00138  
D00198  
D00199  
D00200  
C07498  
C07509  
C13015  
C07514  
C07519

D00138  
D00198  
D00199  
D00200  
C07498  
C07509  
C13015  
C07514  
C07519

D00138  
D00198  
D00199  
D00200  
C07498  
C07509  
C13015  
C07514  
C07519

D00138  
D00198  
D00199  
D00200  
C07498  
C07509  
C13015  
C07514  
C07519

D00138  
D00198  
D00199  
D00200  
C07498  
C07509  
C13015  
C07514  
C07519

D00138  
D00198  
D00199  
D00200  
C07498  
C07509  
C13015  
C07514  
C07519

D00138  
D00198  
D00199  
D00200  
C07498  
C07509  
C13015  
C07514  
C07519

D00138  
D00198  
D00199  
D00200  
C07498  
C07509  
C13015  
C07514  
C07519

D00138  
D00198  
D00199  
D00200  
C07498  
C07509  
C13015  
C07514  
C07519

D00138  
D00198  
D00199  
D00200  
C07498  
C07509  
C13015  
C07514  
C07519

D00138  
D00198  
D00199  
D00200  
C07498  
C07509  
C13015  
C07514  
C07519

D00138  
D00198  
D00199  
D00200  
C07498  
C07509  
C13015  
C07514  
C07519

D00138  
D00198  
D00199  
D00200  
C07498  
C07509  
C13015  
C07514  
C07519

D00138  
D00198  
D00199  
D00200  
C07498  
C07509  
C13015  
C07514  
C07519

D00138  
D00198  
D00199  
D00200  
C07498  
C07509  
C13015  
C07514  
C07519

D00138  
D00198  
D00199  
D00200  
C07498  
C07509  
C13015  
C07514  
C07519

D00138  
D00198  
D00199  
D00200  
C07498  
C07509  
C13015  
C07514  
C07519

D00138  
D00198  
D00199  
D00200  
C07498  
C07509  
C13015  
C07514  
C07519

D00138  
D00198  
D00199  
D00200  
C07498  
C07509  
C13015  
C07514  
C07519

D00138  
D00198  
D00199  
D00200  
C07498  
C07509  
C13015  
C07514  
C07519

D00138  
D00198  
D00199  
D00200  
C07498  
C07509  
C13015  
C07514  
C07519

D00138  
D00198  
D00199  
D00200  
C07498  
C07509  
C13015  
C07514  
C07519

D00138  
D00198  
D00199  
D00200  
C07498  
C07509  
C13015  
C07514  
C07519

D00138  
D00198  
D00199  
D00200  
C07498  
C07509  
C13015  
C07514  
C07519